



POLYURETHANE STOOL MODEL 4001

ASSEMBLY INSTRUCTIONS

877-263-5737
www.buzzseating.com

IN THE BOX COMPONENTS



Base



Caster (Qty. 5)



Cylinder



Back with J Bar



Seat



Footring



Knob



Lock Washer (Qty. 1)



Flat Steel Washer (Qty. 1)

STEP 1

Insert 5 casters into base, push hard until you feel or hear the caster snap into place.

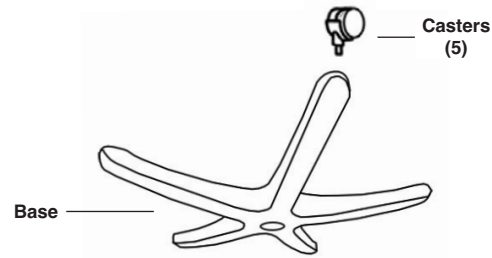

STEP 2

Slide J Bar into seat. Attach with knob using the flat steel washer first and lock washer second.

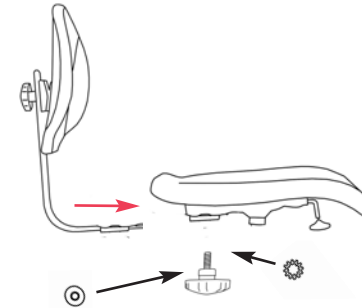

STEP 3

Place tapered end of cylinder into base. **BEFORE PLACING TAPERED END OF CYLINDER INTO BASE COMPLETELY LOOSEN PLASTIC SLEEVE AT BOTTOM OF FOOTRING BY TURNING COUNTER-CLOCKWISE.** Slide footring onto cylinder. Set at desired position. Hold cylinder with one hand and hold footring with other. Turn footring clockwise to tighten.

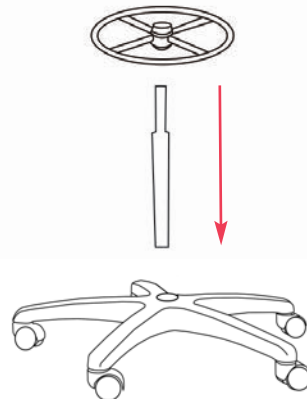

STEP 4

Place assembled seat on top of cylinder and apply downward pressure.

